

RC6702HD

H.264 Full HD Compact Indoor / Outdoor IR Bullet IP Camera

- Full HD1080p @ 30fps
- Video Compression: H.264, MJPEG
- True Day/Night and WDR
- Built-in IR illuminator with Smart IR
- Remote zoom and focus, one click focus**
- MicroSD/SDHC Memory Card Slot
- **ONVIF** Support, IP66, PoE (IEEE 802.3af)
- Embedded VCA Technology Video Analytics
- Burnt-in Text, Video Motion Detection



Specifications

CAMERA		
Model	RC6702HD-6211:	Varifocal lens
	RC6702HD-6311:	Motorized Focus & Zoom lens
Image Sensor	SONY EXMOR 1/2.9" 1080p CMOS	
Effective Pixels	1920 x 1080	
Scanning System	Progressive scanning	
AGC Control	Auto, adjustable amplification level	
Auto IRIS (DC)	Iris control via camera unit	
Minimum Illumination	6211	Color: 0.2 lux (DSS8), - BW: 0.01 lux (IR On)
	6311	Color: 0.2 lux (DSS8), - BW: 0.01 lux (IR On)
Megapixel Lens 1/2.9" M19 - Mount	6211	3.0(w) – 9.0mm(t), F1.5(w) – F2.5(t), Manual Vario; optional changeable to 5-50mm lens (*4)
	6311	2.8(w) – 12.0mm(t), F1.4(w) – F2.6(t), Motorized Focus & Zoom Control – One Click Focus Function, optional changeable to 5-50mm lens (*4)
Angle of View	6211	Horizontal: Approx. 98.2°(Wide) to 37.4°(Tele) Vertical: Approx. 55.2°(Wide) to 21.6°(Tele)
	6311	Horizontal: Approx. 100°(Wide) to 35°(Tele) Vertical: Approx. 54°(Wide) to 20°(Tele)
Shutter Time	1/1000s to 1/2s	
Shutter Exposure Modes	Automatic - with configurable min/max shutter speed (exposure time range) Manual - with configurable fixed shutter speed Flicker-Control - 50/60Hz	
Day & Night Switching	Auto/Manual (both switching level adjustable 1 ~ 64) removable IR Cut Filter	
Image Settings	Configurable brightness, contrast, saturation, sharpness, vertical flip & horizontal mirror function, Corridor Mode (-90° / +90° image flip)	
2D-DNR	Configurable digital noise reduction 1 ~ 16	
Wide Dynamic Range	Up to 100dB Dynamic Range with activated WDR	
Exposure Adjustment	+1.0, +0.6, +0.3, 0, -0.3, -0.6, -1.0 EV	
White Balance	ATW1 / ATW2 / Push / Manual	
DSS (Sens-up)	Configurable digital slow shutter 2X ~ 16X	
Backlight Compensation	BLC On/Off (possible to designate zone)	
Focus Assistant	6311	Video display to simplify the focus point adjustment
SNR	>50db	

IR ILLUMINATOR		
IR LED	6211	High Power IR LED x 12 (850nm)
	6311	High Power IR LED x 16 (850nm)
IR Working Distance	6211	up to 30m
	6311	up to 35m
SMART IR		Automatically adjust the infrared light to the best, according to the brightness of the scene
VIDEO		
Video Compression		H.264 Baseline, Main, High profile (MPEG-4 Part 10/ AVC), MJPEG (Motion JPEG)
Video Streaming Unicast / Multicast		Dual Stream, Independent Configurable H.264: Controllable frame rate and image resolution, bandwidth limitation (CVBR/CBR) MJPEG: Controllable frame rate and image resolution, JPEG quality
Resolutions	16:9 mode	1920x1080, 1280x720, 1120x630, 960x540, 800x450, 640x360, 480x270, 320x180
	4:3 mode	SXGA(1280x960), XGA(1024x768), SVGA (800x600), PAL(720x576), NTSC(720x480) VGA(620x480), QVGA(320x240)
Frame Rate		H.264: Configurable up to max 30fps in all resolution* MJPEG: Configurable up to max 30fps in all resolution*
Motion Detection		Max. 8 zones with independent configuration of detection sensitivity and target object size
Video Stabilization		Supported for First/Second Stream and Snapshot
Defogging		Selectable Defogging level (low, medium, high)
Text Overlay		Free positioning of display for time/ data/ name (name up to 48 signs)
Privacy Mask Zones		4 flexible configurable regions
Analogue Video		NTSC/PAL Video Signal (1.0Vp-p, 75Ω)
NETWORK		
Ethernet Standard/IP		10 / 100 Base-T / IPv4, IPv6
Protocol		QoS Layer 3 DiffServ, TCP/IP, UDP/IP, HTTP, HTTPS, FTP, RTSP, RTP, UDP, RTP/TCP, mDNS, UPnP™, SMTP,DHCP, DNS, DynDNS, NTP, SNMPv1/v2c/v3(MIB-II), IGMP,ICMP, SSLv2/v3, TLSv1, SRTP, RTMP, unicast, multicast
Users Connection		Live viewing for up to 20 clients (unicast *3) Live viewing unlimited users (multicast H.264)
Security		HTTPS(SSL), IP Filtering, Multi-level access with password protection
GENERAL		
I/O Terminal		1x Alarm In - max 50mA@5VDC, TTL 1x Alarm Out - max 50mA@24VDC, TTL

RC6702HD

GENERAL	
Edge Storage	Via micro SD/SDHC (up to 32GB) card for continuous or event recording. Search interface for event files, playback and download (card not included).
Application Programming Interface	Software Development Kit (SDK) available
Event Metadata Streaming RTSP/RTP	Video Motion Detection(MD), Video Content Analytics(VCA)
ONVIF	Version: 2.41 (Support Profile S and G)
Event Sources	Sensor(DI), Video Motion Detection, Tamper Detection, Video Content Analytics(VCA), Network Loss/Detect, Network Setting Change, Time (Recurrere/Schedule)
Event Actions	Notification service via TCP/IP, HTTP, multicast or email text messages with snapshot, DO-contact, file upload on external FTP server, local SD memory card recording
Approvals	FCC, CE, KC, UL, IP66, RoHs
ELECTRICAL	
Power Source	12V DC / PoE (IEEE 802.3af)
Power Consumption	6211 DC 12V, PoE / Max. 12W @ DC 12V
	6311 DC 12V, PoE / Max. 9W @ DC 12V
ENVIRONMENT	
Operation Temperature	DC12V : -20°C ~ 50°C (-4°F ~ 122°F) PoE : -20°C ~ 50°C (-4°F ~ 122°F)
Operating Humidity	Up to 85% RH, Non-condensing
MECHANICAL	
Material	Aluminum Die Casting
Color	White
Dimension	86(W) x 83.5(H) x 287(D)mm (with bracket)
Weight (Approx)	6211 860g (1.90 lbs)
	6311 870g (1.92 lbs)

VIDEO CONTENT ANALYSIS (Included as a Standard)

High Performance	Advanced tracking algorithm and low false alarm rate
Easy to Use	Intuitive web browser interface
Detection Zones and Rules	Up to 40 zones (multi-segment polygons and lines) 60 VCA filter rules in total
On-screen Display	Real-time display of tracking data and events via activeX plug-in in IE browser
Burnt in Annotation	Allows the VCA annotation to be burnt into the raw video stream for displaying on third party application
Tamper Detection	Recognize camera tampering via VCA detection (defocusing, lens covering, camera moving)

VIDEO CONTENT ANALYSIS (Option extension License)

Available License	VCAdetectIP, VCAcountIP, VCAsurveillanceIP, VCAadvancedIP, VCAprofessionalIP
VCA Detection Filters	Objekt: Enter, Exit, Appear, Disappear, Stop, Direction, Dwell, Speed, Unauthorized Access, Counting Line, Color Filter, Object Classification
VCA Features	<ul style="list-style-type: none"> - Up to 20 Onscreen Counter Displays - Counting-Line for accuracy people and vehicle counting with local database and reporting service - VCA calibration via 3D tools for right object size detection - Several definable object class to include into the detection rules for the VCA alarm - 10 colors in total to distinguish objects by color - People tracking mode to tracks individuals separately among overlapped multiple people - Heatmap Report shows relative crowd density of the 24 hour period (criterion: midnight)
Logical Rules	Extension of alarm rules using logical operators (AND, OR..) for the VCA detection filters of created zones / lines
Info VCA	Details regarding supported VCA filters and features of the different extension licenses find on RIVA Product Overview document

Dimension RC6702HD

(Unit: mm)

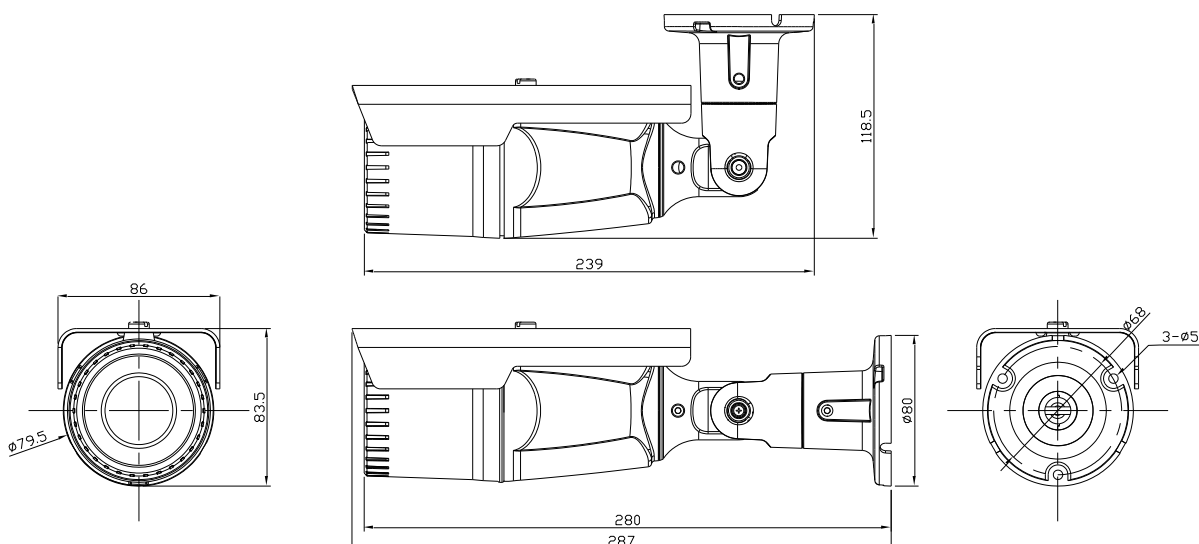

* If VCA is activate, frame rate is limit to max15fps@1080p. Limitations are based on V.1.9.0 firmware release and could be changed without notice

** Only available with RC6702HD-6311

*3 depending on streaming setup and VCA usage

*4 requires front housing change and is subject to availability of the lens

Accessories

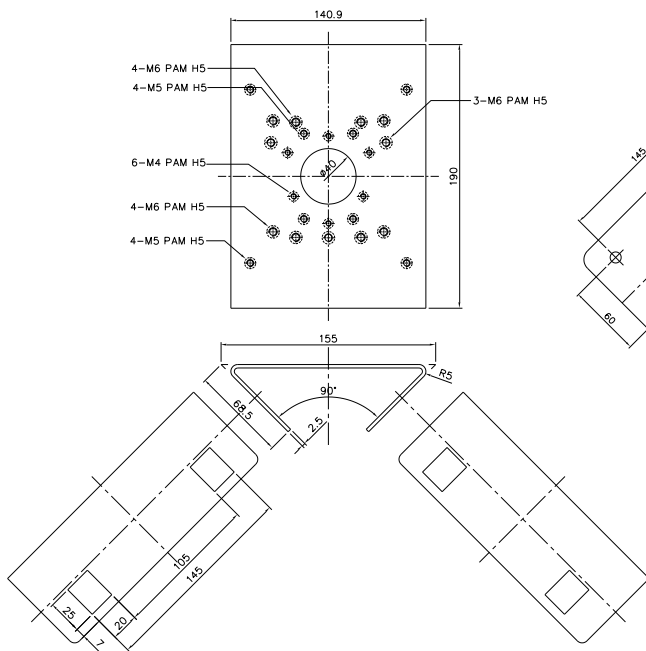

Pole Mount Adaptor

Model: PMA-U100
Weight: 2,28Kg (5.0lbs)

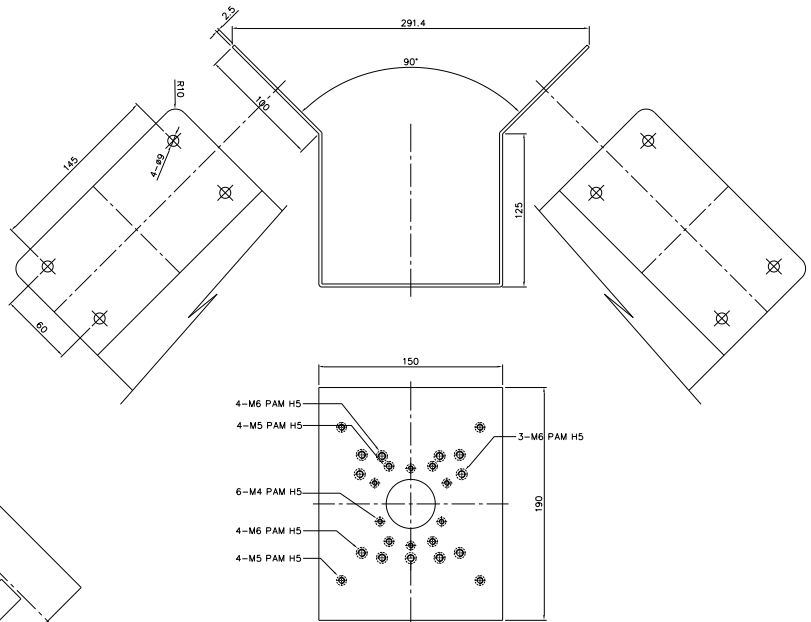

Corner Mount Adaptor

Model: CMA-U100
Weight: 946g (2.1lbs)

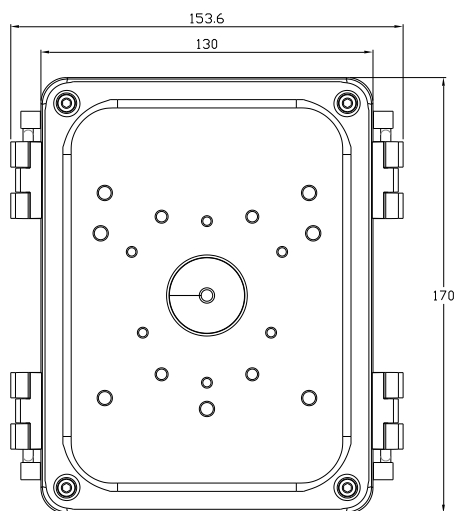

Junction Box

Model: JBK-U100
Weight: 1.02Kg (2.2lbs)